

# SC - Aircraft Nut Type Quick Assembly Connector

SC - 飞机款螺帽型光纤快速连接器

## Introduction

Quick Assembly SC connector can provide quick and easy terminations of fibers in the field. It allows the installer to terminate and make connection in minutes at equipment and fiber patch panels. This connector system with features of high installation quality, high success rate and high reliability. Applicable to 2\*3,2\*1.6 cables.



## Specifications

Parameters	Value	Parameters	Value
Insertion Loss	$\leq 0.35$ dB	Repeatability (500 Mating Times)	$\Delta$ I.L. $\leq 0.35$ dB
Return Loss	$\geq 45$ dB	Temperature cycle	$\Delta$ I.L. $\leq 0.35$ dB
Tensile strength	F>50N	Vibration test	$\Delta$ I.L. $\leq 0.35$ dB
Operating Temp.	-20 ~ +75°C	Flooding test	$\Delta$ I.L. $\leq 0.35$ dB
Storage Temp.	-40 ~ +85°C	Tensile strength	F>50N

## Operation Instruction

### Product Components

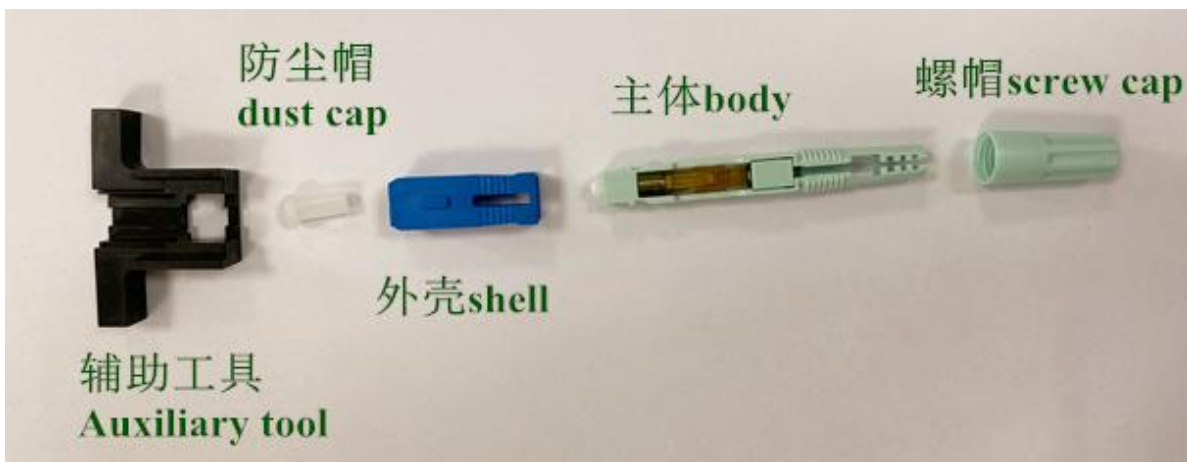

### Necessary Tools



Model: LTS-242  
FTTH Drop Cable Stripper



LTS-212/213  
Fiber Stripper



LFC-300  
Fiber Cleaver



Cutting Clamp

## Operation Steps:

### 1.Process the fiber



Put the cable into the boot

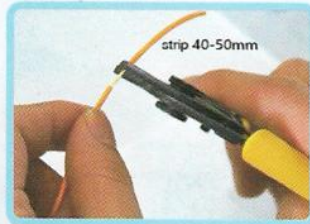

Strip the cable layer



Shear the kevlar line

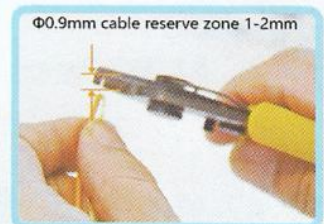

Strip the Φ 0.9 mm cable cover



Strip the Φ 0.25 mm fiber coating layer



Check the fiber



Clean the fiber



Complete stripping

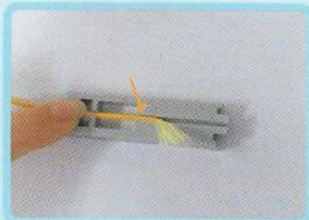

Put the clamp into the cutting clamp



Cut the fiber

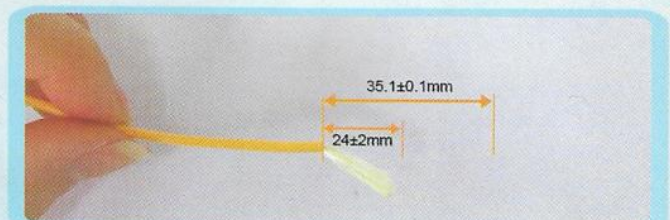

The fiber length specification

### 2.Assembly

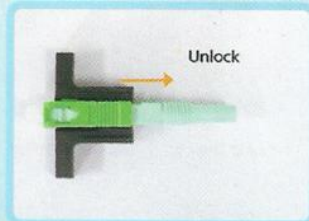

Put the cable into the boot



Insert the fiber



Lock the boot

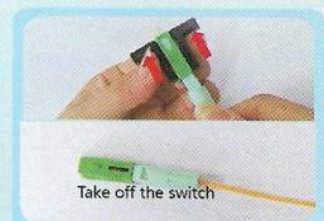

Lock the fiber

### 3.Disassembly

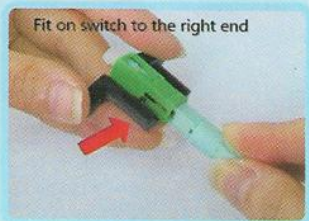

Assembly the auxillary jig

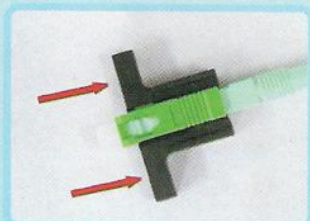

Unlock the fiber



Unlock the boot, Put out the fiber

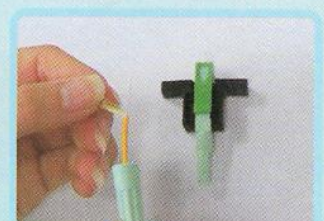

Complete disassembling